

DA 14K-2 tunnel inlet

Technical Info



1 Product description

DA 14K-2 tunnel inlet is used as an air inlet in houses with Tunnel ventilation or Combi-Tunnel ventilation.

The tunnel inlet can be mounted outwards directly on the wall or sandwich panel.

When installing the tunnel inlet outside, the inlet does not occupy space inside the housing. It also prevents animals from getting hold of strings or connectors.

The tunnel inlet is made of thermoplastic.

The inlet is delivered with the inlet flaps installed. Regulation set is installed on-site.

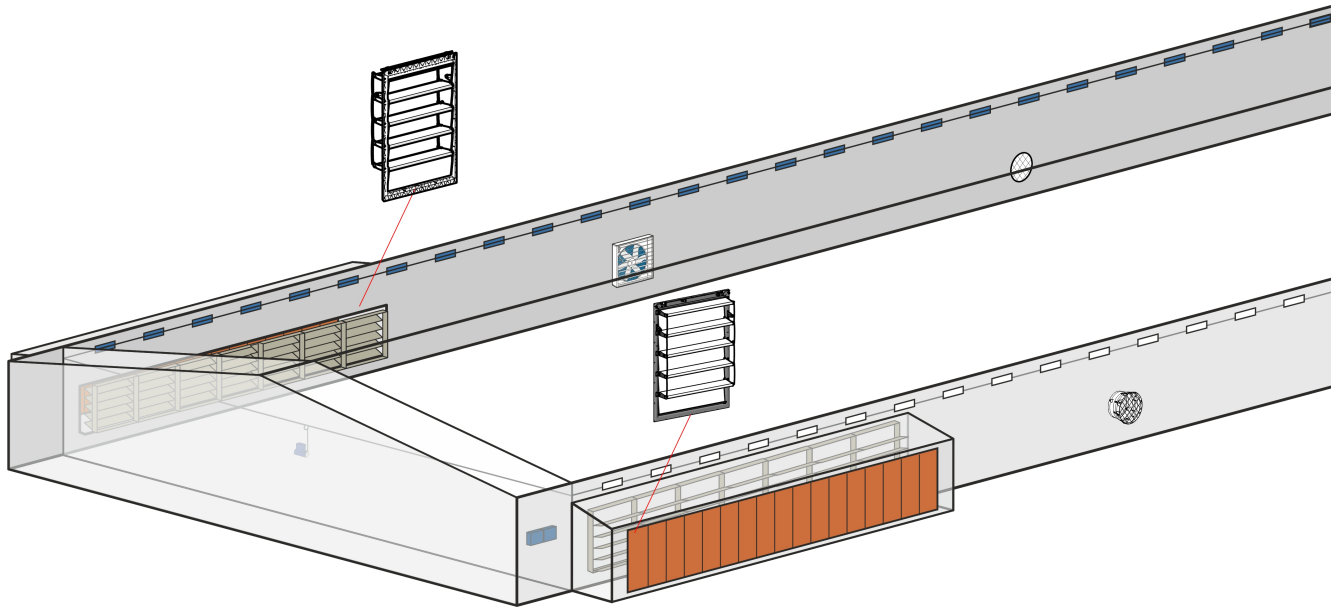

2 Product survey

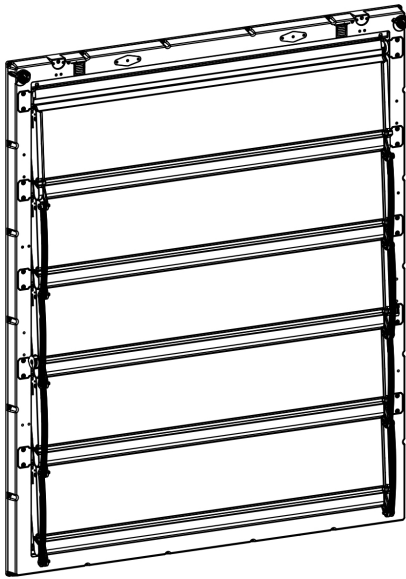

433722 DA 14k-2 Tunnel inlet, semi-insulated Outside

Used for mounting outside on wall where insulation is not necessary.

When installing the tunnel inlet externally, the inlet does not occupy space inside the housing. It also prevents animals from getting hold of strings or connectors.

The mounting parts are used for assembling the tunnel inlet.

The tunnel inlet must always be protected against direct sun, wind and weather influences - e.g. by placing the tunnel inlets in combination with either cooling pads, light trap flex or the like.

3 Technical Data

Mechanical		
Material		100% recyclable thermoplastic, high-impact material, dimensionally stable and UV stabilized
Springs		Stainless steel
Color - inlet frame		Grey (RAL 7024)
Color - inlet flap		Light gray (RAL 7035)
Tensile force 0 Pa	kg	20
Tensile force -5 Pa	kg	20
Tensile force -10 Pa	kg	20
Tensile force -20 Pa	kg	20
Tensile force -30 Pa	kg	20
Tensile force -40 Pa	kg	20
Max. tensile length	mm	600
Output		
Air output at - 5 Pa	m ³ /h	8900
Air output at -10 Pa	m ³ /h	12600
Air output at -20 Pa	m ³ /h	17800
Air output at -30 Pa	m ³ /h	21700
Air output at - 40 Pa	m ³ /h	25100
Airtightness level		
Airtightness level at 10 Pa	m ³ /h	20*
Airtightness level at 40 Pa	m ³ /h	41
Environment		
Temperature, operation	°C	-40 to +50 – and protected against direct sunlight.
Temperature, storage	°C	-40 to +65 – and protected against direct sunlight.
Ambient humidity, operation	% RH	0-95% RH
Shipment		
Dimensions HxWxD [mm] per layer	mm	1600×1350×125
Weight per piece	kg/pcs.	19.5
Number of inlets per pallet	pcs.	19

*The test set-up cannot measure air flow below 20 m³/h. Therefore, the airtightness level is adjusted to 20 m³/h.

3.1 Dimension drawing for tunnel inlet

Dimensions in mm

Hole dimensions for tunnel inlet.

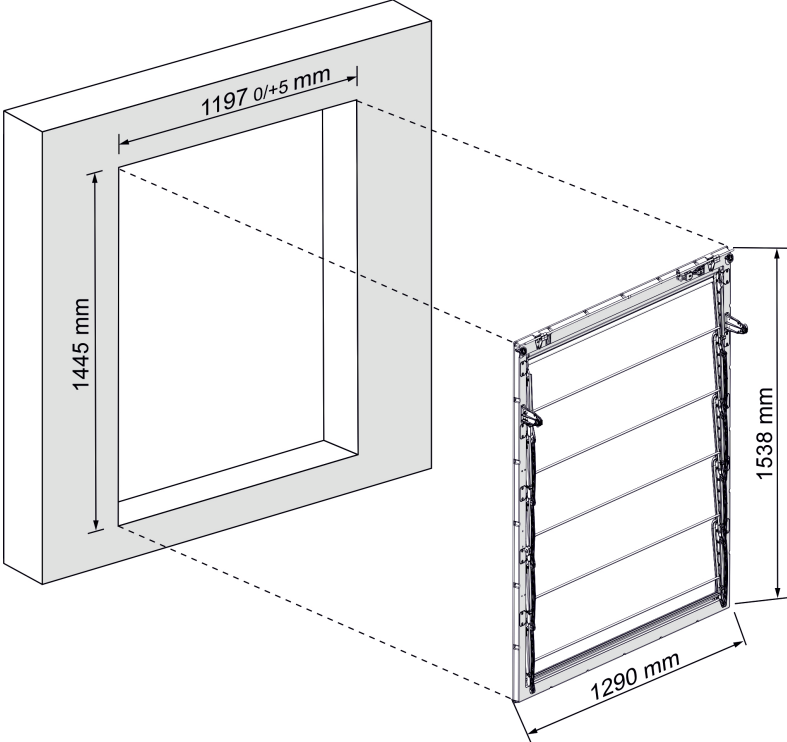

Dimensions for tunnel inlet.

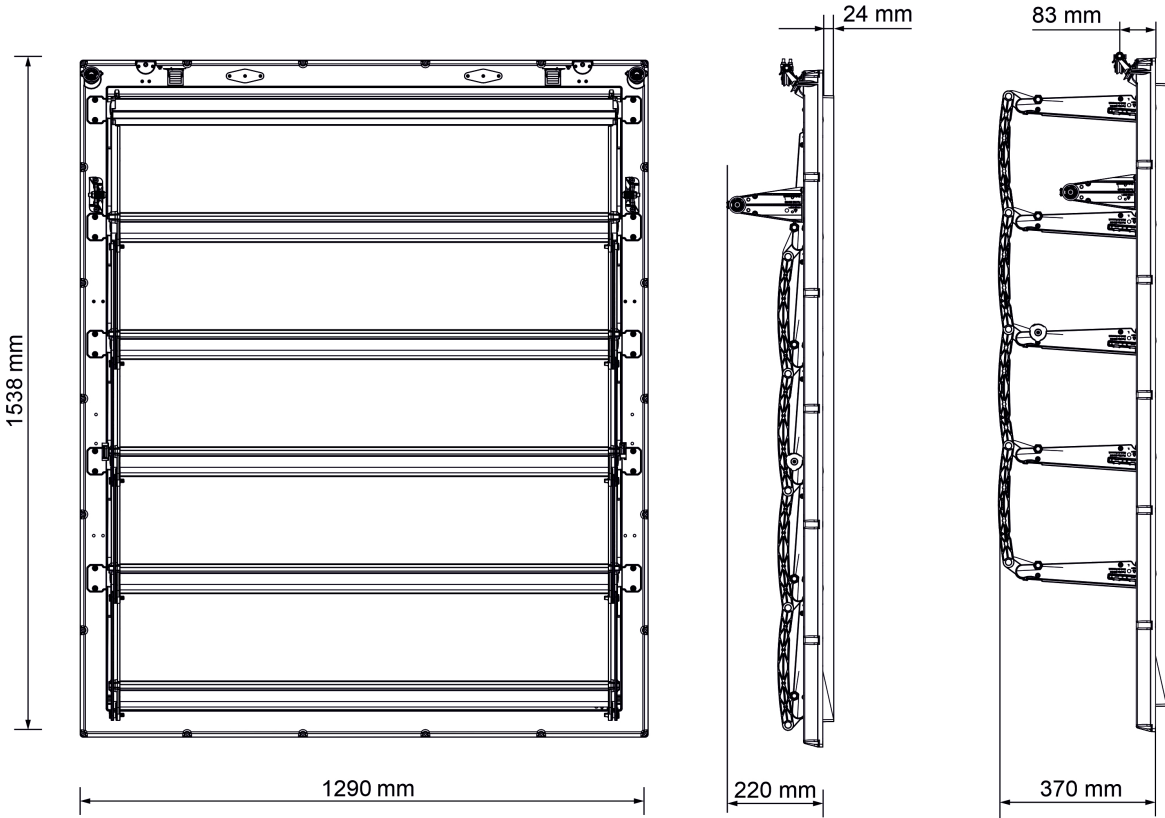

SKOV A/S • Hedelund 4 • Glyngøre • DK-7870 Roslev
Tel. +45 72 17 55 55 • www.skov.com • E-mail: skov@skov.dk

