

DOL 192 Egg Counter

Technical Info



1	Product description	3
2	Product survey	4
2.1	Accessories.....	5
3	Technical data	6
3.1	DOL 192 12 - 20 cm.....	6
3.2	DOL 192 30 - 75 cm.....	7

1 Product description

The DOL 192 Egg Counter is intended for automatic counting of eggs on a conveyor belt. It is touch-free and functions with the aid of an infra-red light. This reduces the risk of injuries, contamination and ensures an unrestricted flow of eggs on the conveyor belt.

The DOL 192 Egg Counter is available in 7 different variants (2 small 24 V DC and 5 large 230 V AC egg counters), so that it fits the conveyor belt.

- DOL 192 12 cm scan width 120 mm, 24 V DC is suitable for counting eggs on longitudinal conveyor belts.
- DOL 192 20 cm scan width 120 – 200 mm, 24 V DC is suitable for counting eggs on longitudinal conveyor belts.
- DOL 192 30/40/50/60/75 cm scan width 223 – 760 mm, 230 V DC are suitable for counting eggs on conveyor belts that collect eggs from more than one longitudinal conveyor belt.

The DOL 192 egg counter provides 1 pulse per egg to a DOL 53X house controller (version 2.2 or newer).

The DOL 192 Egg Counter is accurate to at least 99.5% when installed correctly.

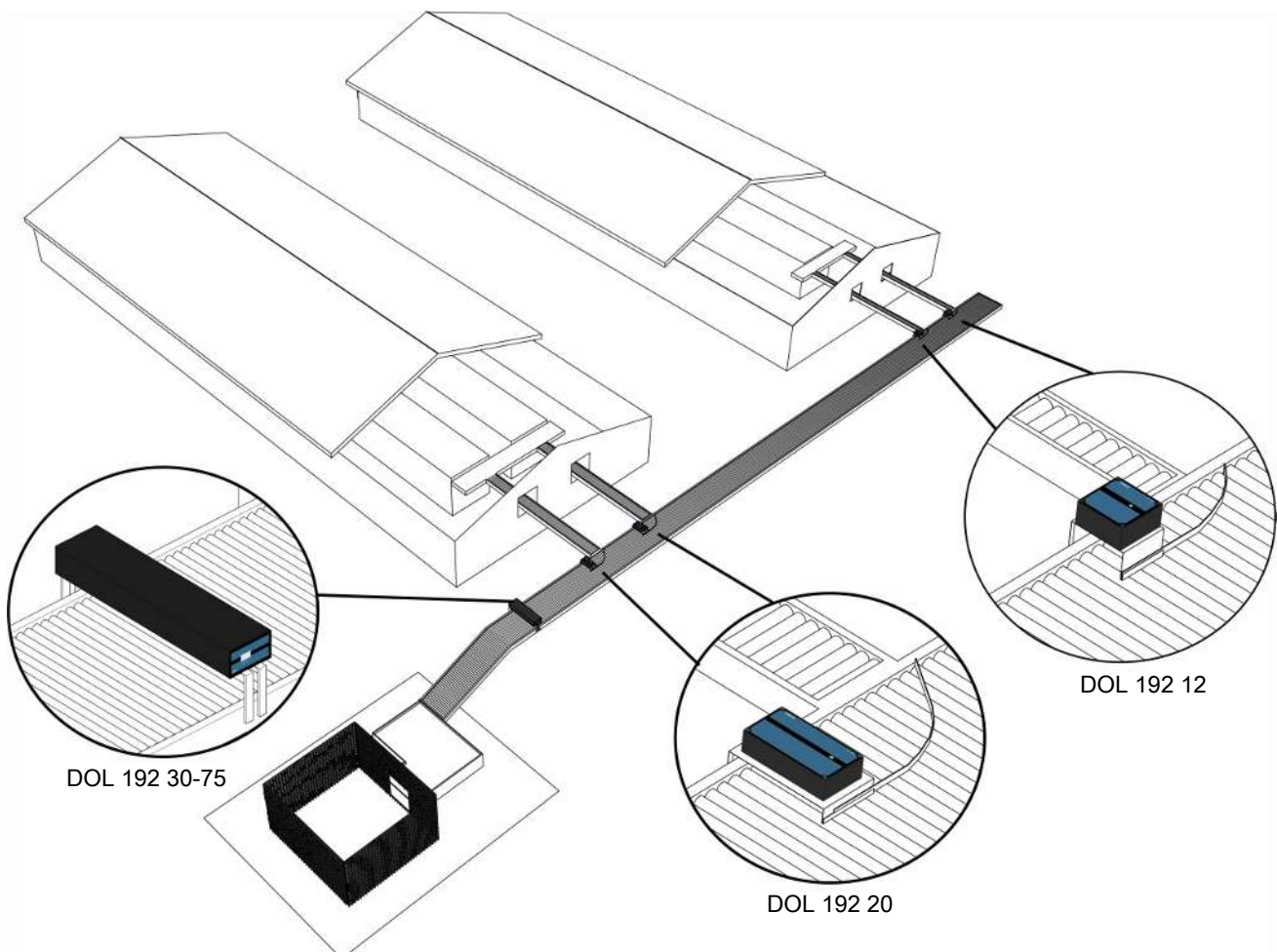

2 Product survey

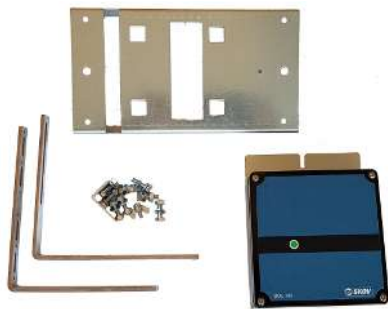

130306 DOL 192 12 cm wo/display w/fitting

Scan width 120 mm

Includes rail

The DOL 192 12 cm Egg Counter is suitable for counting eggs on longitudinal conveyor belts.

The DOL 192 12 cm Egg Counter must be powered using a 24 V DC external power supply (135752).

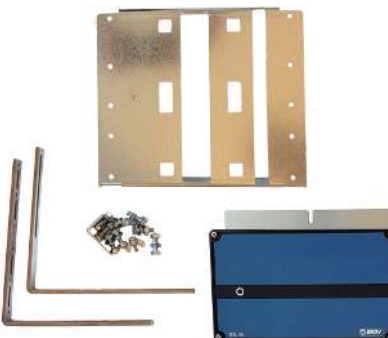

130331 DOL 192 20 cm wo/display w/fitting

Scan width 120 – 200 mm

Includes rail

The DOL 192 20 cm Egg Counter is suitable for counting eggs on longitudinal conveyor belts.

The DOL 192 20 cm Egg Counter must be powered using a 24 V DC external power supply (135752).

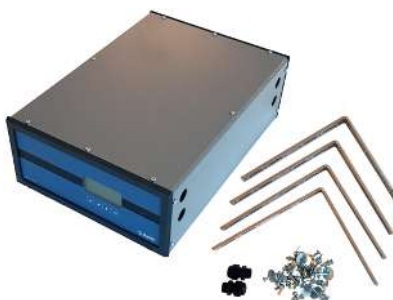

130332 DOL 192 30 cm w/display+fitting

Scan width 223 – 303 mm

130333 DOL 192 40 cm w/display+fitting

Scan width 314 – 394 mm

130334 DOL 192 50 cm w/display+fitting

Scan width 405 – 486 mm

130335 DOL 192 60 cm w/display+fitting

Scan width 497 – 577 mm

130336 DOL 192 75 cm w/display+fitting

Scan width 680 – 760 mm

The DOL 192 30 cm to 75 cm is suitable for counting eggs on conveyor belts that collect eggs from more than one longitudinal conveyor belt.

The DOL 192 30 cm to 75 cm Egg Counter must be powered using 230 V AC.

The DOL 192 30 cm to 75 cm is supplied with a display, where the number of eggs can be read locally. In addition, the number of eggs per day for a maximum of 7 days can be read in the log.

2.1 Accessories



135752 Power supply 24V, 2.1A in box

Extra power supply

Voltage 90 – 264 V
Frequency 47-63 Hz
Power 160 VA
Current 0.7 A

Output

Voltage 24 +/- 10 %
Current 2.1 A



136470 DOL Ext. box Small 10RL

Extension box with one I/O module, 10RL 8AI 8AO, type 15

Includes rubber sleeves and ribbon cable

10 x relays
8 x 0-10V inputs
8 x 0-10V outputs



136471 DOL Ext. box Small 20RL

Extension box with two I/O module, 10RL 8AI 8AO, type 15

Includes rubber sleeves and ribbon cable

20 x relays
16 x 0-10V inputs
16 x 0-10V outputs

3 Technical data

3.1 DOL 192 12 - 20 cm

		DOL 192 12	DOL 192 20
Electrical			
Operating voltage	V DC	8 - 30	
Max. power	W	1	2
Standby input			
Input impedance	kΩ	15	
Standby level	V	8	
Pulse output 1 egg per pulse			
Open collector transistor		NPN	
Supply current	mA	25	
Resistance	Ω	100	
Pulse time LOW/HIGH	ms	150/150	100/100
Measuring range			
Scan width	mm	120	120 - 200
Scan width (installed at a height of 62 mm)	mm	25 - 50	
Appropriate speed on conveyor belt	m/min	2.5 – 8	2.5 – 8
Environment			
Temperature, operation	°C	0 - 40	
Protection class	IP	53	
Shipping			
Dimensions (H x W x D)	mm	55x120x122	55x120x200
Dimensions crated H x W x D		100x230x310	100x230x310
Weight	g	700	1000
Shipping weight		1550	1960

3.2 DOL 192 30 - 75 cm

		DOL 192 30	DOL 192 40	DOL 192 50	DOL 192 60	DOL 192 75
Electrical						
Rated voltage	V AC	230				
Operating voltage	V AC	207 - 253				
Frequency	Hz	50/60				
Max. power	W	12				
Standby input						
Digital input		NPN / PNP				
Voltage	V DC	12 - 24				
Supply current	mA	8				
Pulse output 1 egg per pulse						
Open collector transistor		NPN				
Supply current	mA	25				
Resistance	Ω	100				
Pulse time LOW/HIGH	ms	100/100				
Measuring range						
Scan width	mm	223 - 303	314 - 394	405 - 486	497 - 577	680 - 760
Scan width (installed at a height of 62 mm)	mm	25 - 50				
Appropriate speed on conveyor belt	m/min	2.5 – 8				
Environment						
Temperature, operation	$^{\circ}\text{C}$	0 - 40				
Protection class	IP	52				
Shipping						
Dimensions (H x W x D)	mm	107x225x315	107x225x406	107x225x498	107x225x589	107x225x772
Dimensions crated H x W x D	mm	200x290x370	175x315x415	200x300x600	300x375x578	180x285x1010
Weight	g	3700	4600	5500	6400	8200
Shipping weight	g	4700	5600	6500	7400	9200

SKOV A/S • Hedelund 4 • Glyngøre • DK-7870 Roslev
Tel. +45 72 17 55 55 • www.skov.com • E-mail: skov@skov.dk

